

ASSEMBLY NO. OF UNPLATED TERM. AND CLIP	UNPLATED TERMINAL	SPRING CLIP STAINLESS ST'L.	WIRE GAUGE	DIM. 'A'	DIM. 'B'
TF-10PC1UC 023432	TF-10PC1UI 030471 12020400 51515	TX-FSC 026505 51591	10-12	.190	.295
TF-14PC1UC 023433	TF-14PC1UI 030479 12020321 51519	TX-FSC 026505 51591	14-16	.180	.240
TF-18PC1UC 023434	TF-18PC1UI 030478 12020334 51518	TX-FSC 026505 51591	18-20	.135	.185
TF-13PC1UC 023435	TF-13PC1UI 030436 12020335 51517	TX-FSC 026505 51591	(2) 14-16	.225	.320
TF-17PC1UC 023436	TF-17PC1UI 030435 12020336 51516	TX-FSC 026505 51591	(2) 18-20	.175	.275

ASSEMBLY NO. OF SILVER PLATED TERM. AND CLIP	SILVER PLATED TERMINAL	SPRING CLIP STAINLESS ST'L.	WIRE GAUGE	DIM. 'A'	DIM. 'B'
FARGO ASS'Y. NO. OLD ASS'Y. NO.	FARGO TERM NO. OLD FARGO NO. PACKARD NO. ETCO NO.	FARGO CLIP NO. OLD FARGO NO. ETCO NO.		±.010	±.010
TF-10PC1SC 023438	TF-10PC1S 030462 12048277 51885	TX-FSC 026505 51591	10-12	.190	.295
TF-14PC1SC 023439	TF-14PC1S 030463 12048278 51886	TX-FSC 026505 51591	14-16	.180	.240
TF-13PC1SC	TF-13PC1S 51937	TX-FSC 026505 51591	(2) 14-16 OR 10-12	.225	.320
TF-18PC1SC 023440	TF-18PC1S 030464 12048279 XXXXXX	TX-FSC 026505 51591	(2) 18-20	.175	.275

REV	REVISION DATE	RELEASE NUMBER	DESCRIPTION	DRAWN BY	CHECKED BY	APPROVED BY
01	7-18-96		DRW. WAS #023432-TAB REDRAWN ON CAD06	SJB	JCB	REF
02	5-09-02	2879	ADDED MAT'L SPEC	SJB	JCB	REF
03	2-20-02	3084	ADDED ETCO NUMBERS OBSOLETE TF-10PCIS AND TF-18PC1SC	SJB	JCB	REF
04	5-28-03	3259	REMOVED TIN PLATED TERMINAL AND 'B' DIM'S. 'A'	SJB	JCB	REF
05	4-15-04	3575	REMOVED OBSOLETE FROM #TF-10PC1SC	SJB	JCB	REF
06	2-02-08	5243	CHANGED TOLERANCE .005 WAS .002 .010 WAS .005 .020 WAS .010	SJB	JCB	REF

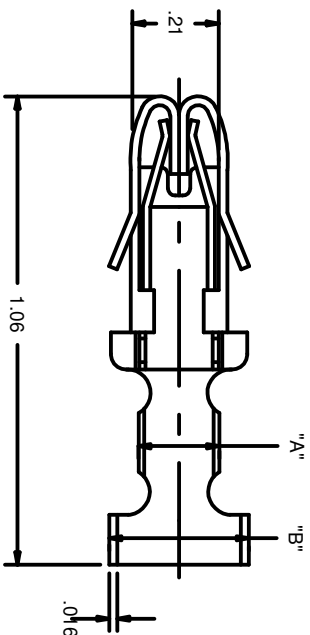

- NOTES:
- 1- UNPLATED TERMINAL - MAT'L. IS BRASS #CA260
  - 2- PLATED TERMINAL - MAT'L. IS COPPER #CA195

FILE # 890710-1	SHEET 1 OF 1	FARGO ASSEMBLY OF PA
DRAWN BY: SJB	CHECKED BY: JCB	DATE: 07/18/96
APP'D BY: SJB	DATE: 07/18/96	TITLE: AUTOFUSE TERMINAL WITH SPRING CLIP
PROJECT: 960710-1	REV: 06	DATE: 07/18/96